

## STORA SUPER 400 - H460

with D400 slotted ductile iron gratings, 15mm slot



EN1433:2005

D400



### DESCRIPTION

Polyester concrete drainage channel with cast iron protective edge profile, width 400, height 460 and 2 gratings D400 ductile iron, 13mm "WAVE" slot. Solid construction, good chemical resistance, integrated ductile iron profile, with security joint.

### AVANTAGES DU PRODUIT

- Grating: 2 gratings ductile iron, 15mm slot
- Waterway area of the 2 gratings: 12,60 dm<sup>2</sup>
- Hydraulic capacity of the 2 gratings: 41,40 L/sec
- Opening between bars <20mm. To guarantee the accessibility of public places for disabled persons, the slots of the gratings with the disabled-symbol are never larger than 20mm.
- Gratings with unique anti-skid surface
- Grating fixing system: 4 M10 stainless steel bolt per grating
- The channels are assembled against each other by means of a tongue and groove jointing system (male/female); to ensure the channels watertightness it is recommended to use a suitable elastic polyurethane sealant.

### MATERIAL

- Channel: polyester concrete
- Protective edge profile: ductile iron GJS 500-7 following EN1563
- Grating: ductile iron GJS 500-7 following EN1563

### COATING

Grating: Non-toxic and non-polluting black water paint

### CERTIFICATION

Certified EN 1433:2005

### PLACE OF INSTALLATION

Group 4, Class D400 → see EN1433

Load traffic lanes (including pedestrian streets), hard shoulders and parking areas, for all types D 400 of road vehicles.

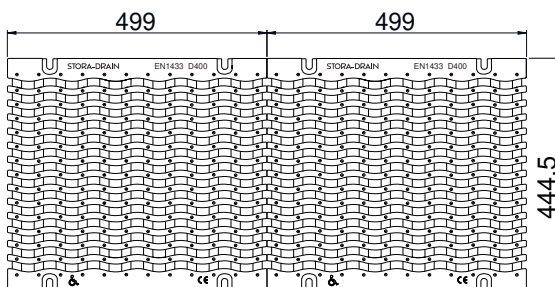
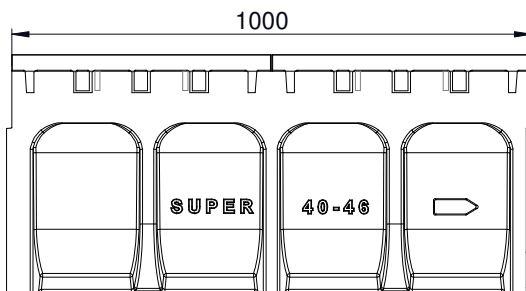
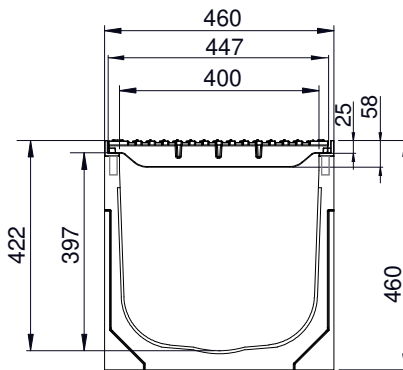

### REFERENCE

Stora-Super 400 H460 slotted gratings D400 ductile iron, 15mm slot.

### ARTICLE N°

SU40461368

### KG

140,60

### UNITS PER PALLET

4

Sizes in mm - Weights, sizes and sketch are indicative - Uncontrolled distribution.